

Active Transportation (AT) Fence - 2100 mm

The Active Transportation (AT) Fence is used in conjunction with the Urban Barrier (sold separately) and provides high-class protection for pedestrians, patio diners, and cyclists. No additional weights or feet minimizes the potential risk of tripping. The AT Fence can also be mounted on a foot plate as a traditional perimeter fence.

- No sharp edges or loose parts
- No protruding weights or feet reduces tripping hazards
- The net panel is clearly visible thanks to its contrasting yellow colour
- Total height when fitted to Urban Barrier: 7' 8" (2350 mm)

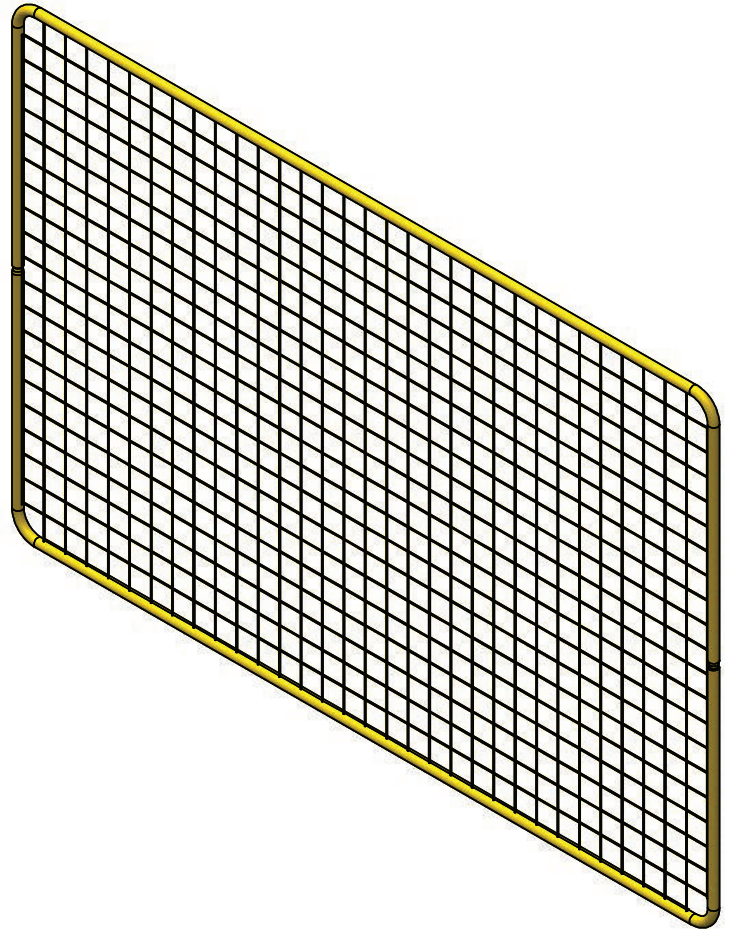

Galvanized Steel



12.5



Stinson TRAFFIC SAFETY
SPECIALISTS

Get expert advice or place an order at
stinson.ca | 1-800-561-6639

[mm]

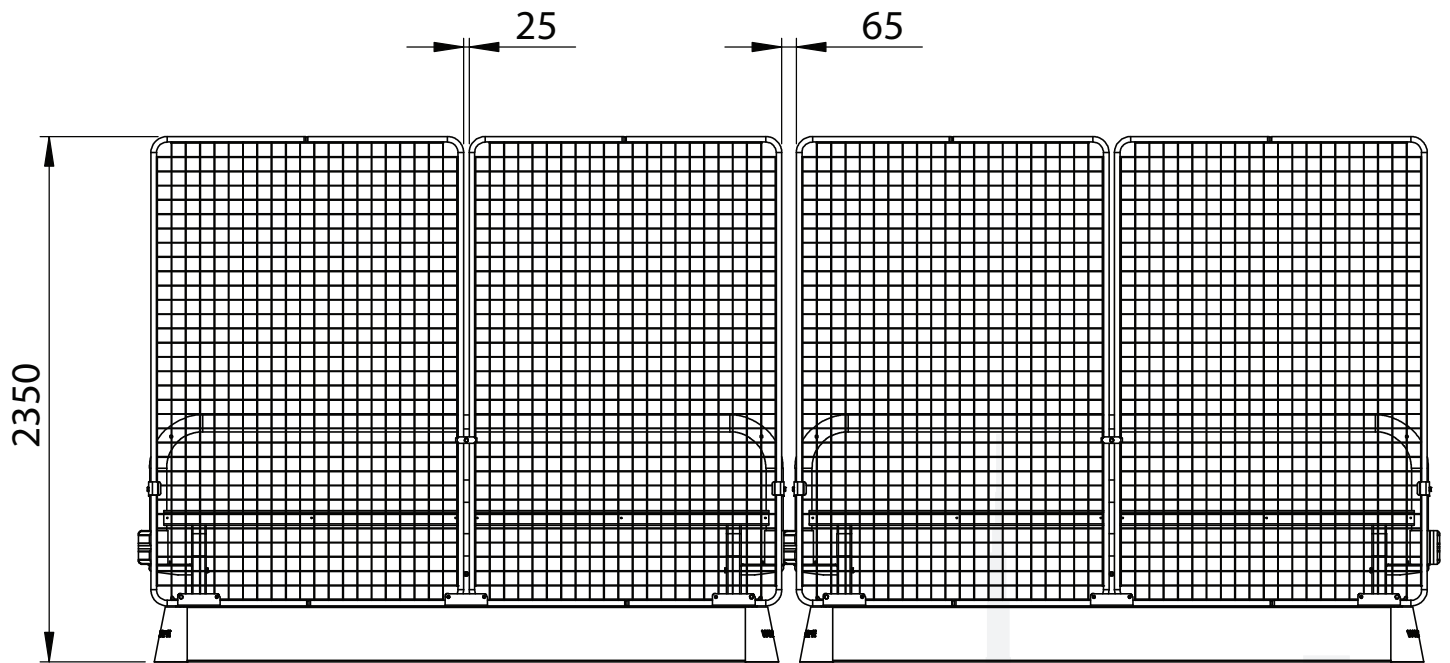
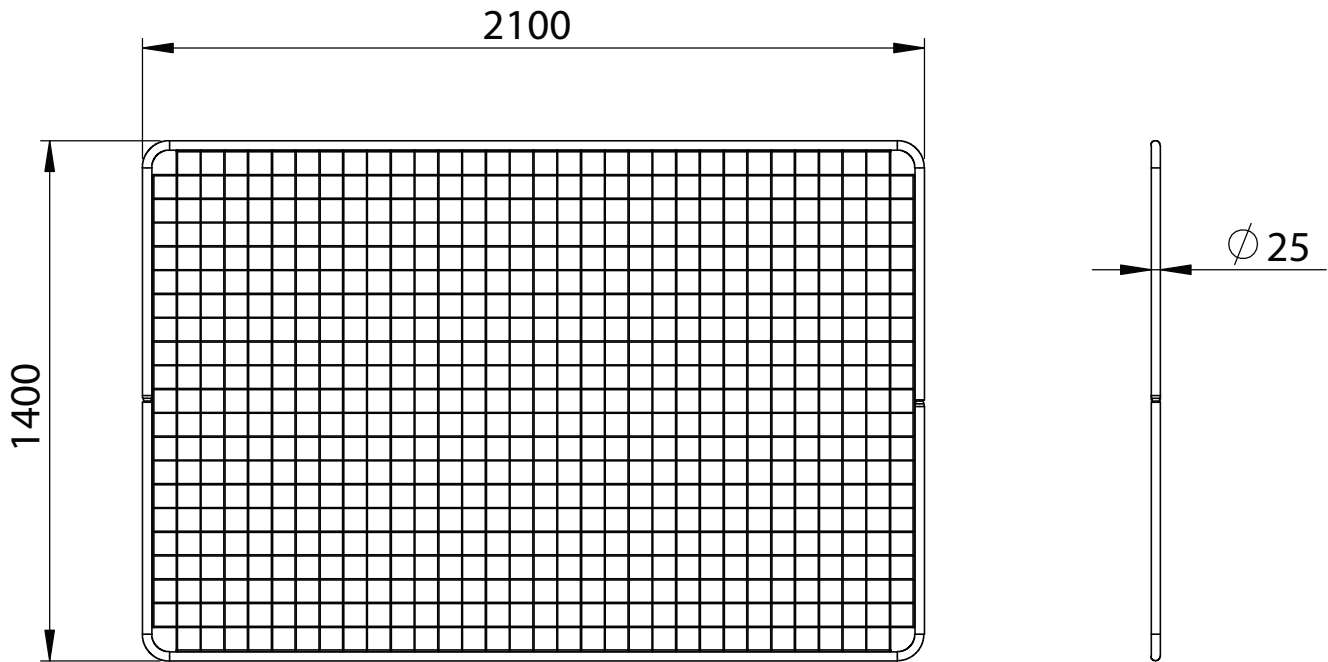

Stinson TRAFFIC SAFETY
SPECIALISTS

Get expert advice or place an order at
stinson.ca | 1-800-561-6639

1 x 832833

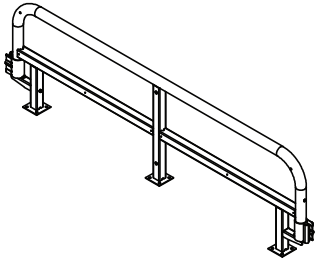

2 x 833191

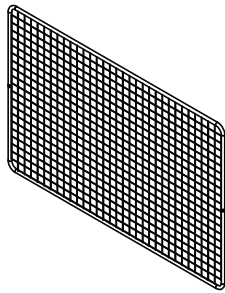

1 x 833252

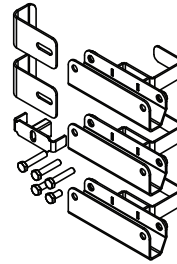

1.

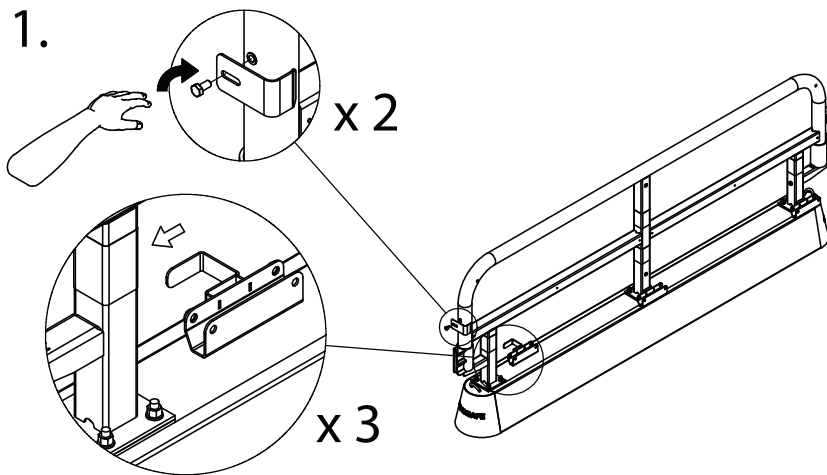

2.

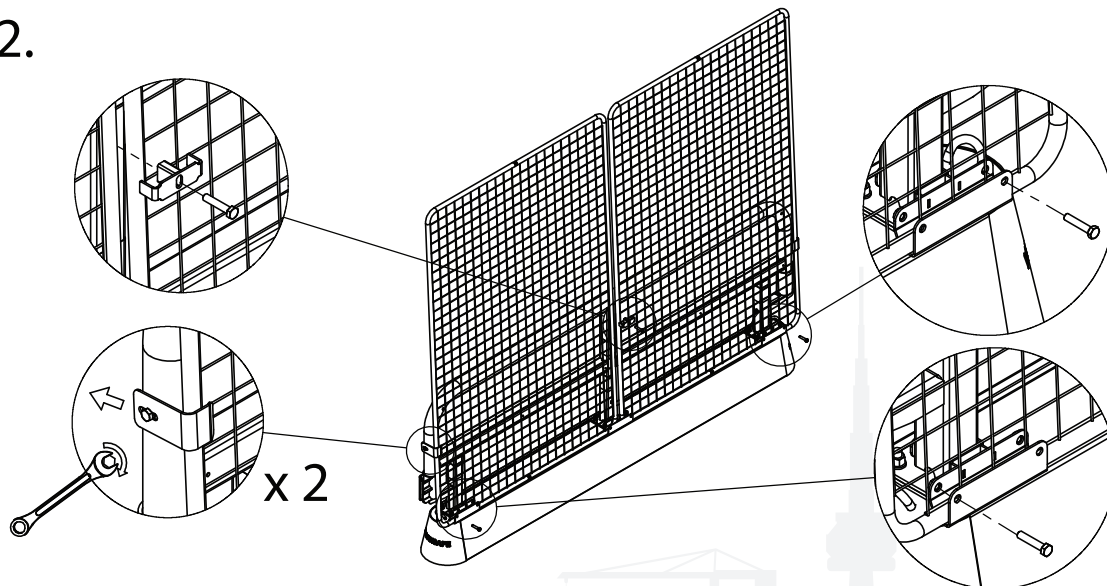

Stinson TRAFFIC SAFETY
SPECIALISTS

Get expert advice or place an order at
stinson.ca | 1-800-561-6639